

# HIGH QUALITY, EFFICIENT OPERATION, SPACE-SAVING DESIGN

The imageRUNNER ADVANCE 4500 Series is designed to deliver consistent and reliable performance to busy departments and work environments. With an efficient, compact design, these intelligent systems work seamlessly within fleet environments, offer an intuitive user experience, and integrate with Canon's holistic business solutions to help address your needs.

Print up to 51 ppm in black and white

Scan up to 160 ipm (300 dpi) (BW, color, duplex)

Print up to 11" x 17"

6,330-sheet maximum paper capacity



## Workflow Efficiency

- An intuitive user interface with a large, responsive, color touch-screen with smartphone-like usability helps make it easy to carry out tasks.
- My ADVANCE enables users to have a unique, customized experience that's tailored to their specific workflow needs. Settings, such as display language, initial log-in screen, and accessibility options, can be synchronized across multiple devices for consistency.
- Canon's MEAP platform supports a range of integrated solutions designed to help simplify workflow and achieve a holistic business solution.
- Scalable support for mobile and flexible work styles can help increase efficiency by allowing workers to capture or print documents and access certain cloud applications.<sup>1</sup>
- Scan and convert documents to Searchable PDF, Microsoft® Word, and Microsoft PowerPoint® files through a single-pass, duplexing document feeder that holds up to 150 originals.
- Intelligent features, such as motion sensor technology to wake the device from Sleep mode and the ability to remove blank pages when scanning, can help maximize productivity.

## Security<sup>2</sup>

- Control device access by using the standard Universal Login Manager application for authentication.
- Help limit unauthorized distribution of sensitive information with an array of standard and optional document security features.
- Help facilitate information privacy and security by controlling access with IPsec, port filtering capabilities, and SSL technology.

## Cost Management

- The ability to apply print policies, monitor output, and restrict usage by user can help reduce unnecessary printing, enable cost recovery, and help save money on paper and toner.
- Tight integration with a variety of output management solutions, such as optional uniFLOW, provides the ability to carry out detailed tracking, reporting, and cost analysis.
- Quality and reliability, combined with remote diagnostics contribute to maximizing uptime and can help reduce time spent by IT resolving issues.
- Consistent user operation, paired with remote and centralized fleet management, can help simplify IT management of a single device or a fleet of devices.



## Device and Fleet Management

- The ability to preconfigure devices makes installation easy, and fleet management is simplified with the ability to synchronize settings across multiple compatible devices.
- Canon's device management tools provide a centralized point of control across a fleet of devices, including the ability to check device status and consumables, turn off devices remotely, capture meter readings, and manage address books and printer drivers.
- Standard genuine Adobe® PostScript® and PCL® support integration with enterprise applications, and legacy systems help streamline business processes.

## Quality and Reliability

- Canon's signature reliability and engine technologies contribute to high-quality output to meet the needs of busy departments.
- Outstanding imaging technologies and toner allow for consistent images in rich black-and-white tones and 1200-dpi print resolution.
- Designed to achieve maximum uptime with status notifications to help keep supplies replenished. These models also include intuitive user maintenance videos, the ability to replace toner on the fly, and automatic job rerouting (with optional solutions).

## Sustainability

- Fusing technologies, QF toner, and selectable Sleep mode settings help achieve low energy consumption.
- Help minimize waste with default two-sided printing, the Secure Print feature, and the ability to hold print jobs, preview them, and change print settings at the device so you can achieve the results you want the first time.
- ENERGY STAR® certified and rated EPEAT® Gold.<sup>3</sup>

## Configuration

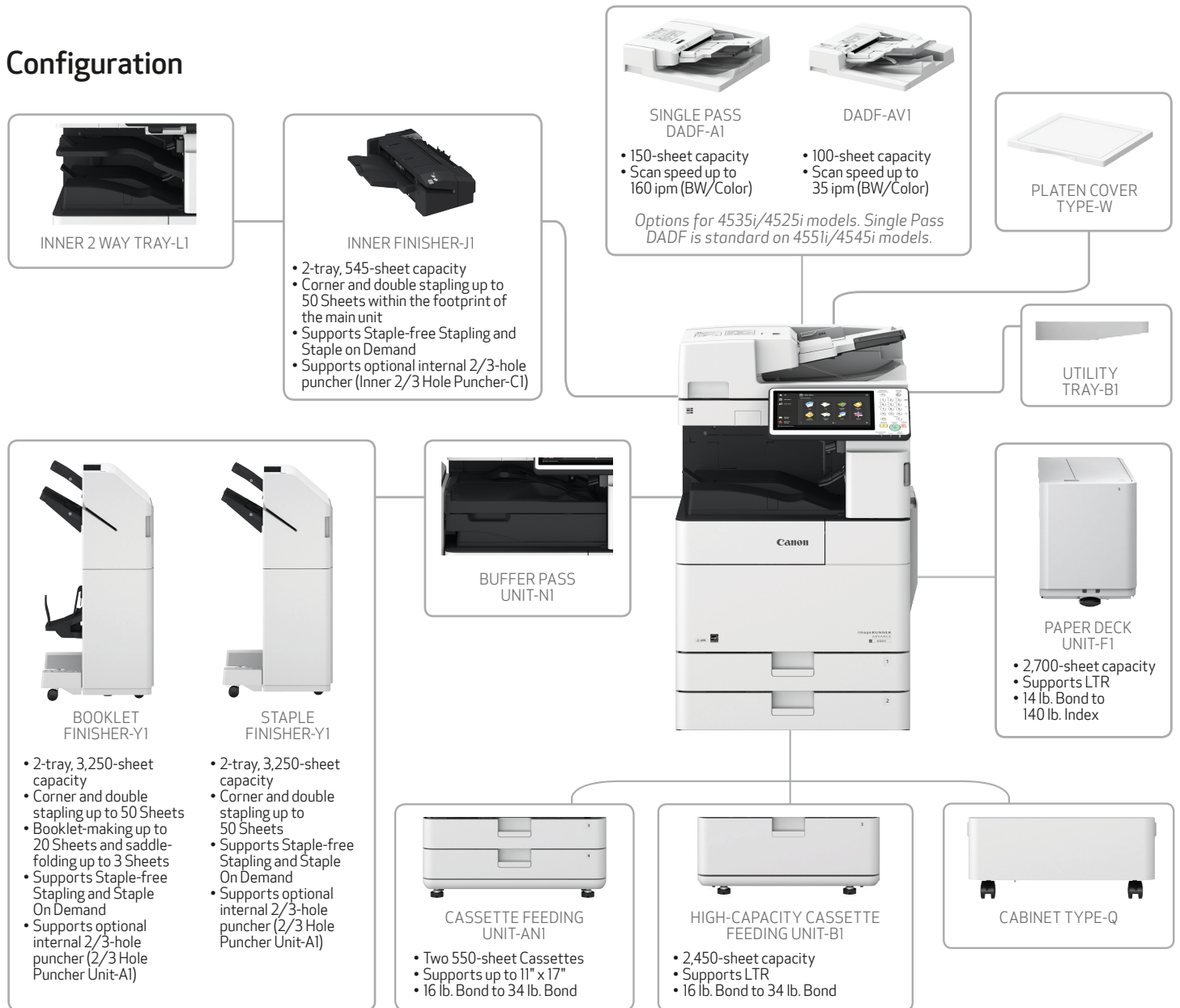

Not Shown

- INNER 2/3-HOLE PUNCHER-C1 (for Inner Finisher-J1)
- 2/3-HOLE PUNCHER UNIT-A1 (for External Finishers)

## Main Unit

### Type

Monochrome Laser Multifunctional

### Core Functions

Standard: Print, Copy, Scan, Send, Store

Optional: Fax

### Processor

Canon Dual Custom Processor (Shared)

### Control Panel

10.1" TFT LCD WSVGA Color Touch-panel

Memory: 3.0 GB RAM

### Hard Disk Drive

Standard: 250 GB/Maximum: 1 TB

Print Resolution: 1200 dpi x 1200 dpi

### Interface Connection

#### Network

Standard: 1000Base-T/100Base-TX/10Base-T,  
Wireless LAN (IEEE 802.11 b/g/n)

Optional: NFC, Bluetooth

#### Others

Standard: USB 2.0 x2 (Host), USB 3.0 x1 (Host),  
USB 2.0 x1 (Device)

Optional: Serial Interface, Copy Control Interface

### Paper Capacity (LTR, 20 lb. Bond)

Standard: 1,180 Sheets

Maximum: 6,330 Sheets

### Paper Sources (LTR, 20 lb. Bond)

Standard: Two 550-sheet Paper Cassettes,  
80-sheet Stack Bypass

Optional: Two 550-sheet Paper Cassettes  
(Cassette Feeding Unit-AN1), 2,450-sheet  
Paper Deck (High Capacity Cassette  
Feeding Unit-B1), 2,700-sheet Paper Deck  
(Paper Deck Unit-F1)

### Paper Output Capacity (LTR, 20 lb. Bond)

Standard: 250 Sheets

Maximum: 3,350 Sheets (with External Finishers)

### Finishing Capabilities

Standard: Collate, Group

With Inner Finisher: Collate, Group, Offset, Staple,  
Hole Punch,<sup>4</sup> Staple-Free Staple,  
Staple On Demand

With External Finisher: Collate, Group, Offset, Staple, Booklet,<sup>5</sup>  
Staple-Free Staple, Staple On Demand,  
Hole Punch<sup>6</sup>

### Supported Media Types

Paper: Thin, Plain, Recycled, Color, Heavy,  
Cassettes: Pre-punched

Stack Bypass: Thin, Plain, Recycled, Color, Heavy,  
Pre-punched, Bond, Transparency,  
Label, Envelope

### Supported Media Sizes

Paper: Legal, Letter, Letter-R, Executive,  
Cassette (1): Statement-R, Custom Size  
(5-1/2" x 7-1/8" to 11-3/4" x 15-3/8")

Paper: 11" x 17", Legal, Letter, Letter-R,  
Cassette (2): Executive, Statement-R, Custom Size  
(5-1/2" x 7-1/8" to 11-3/4" x 15-3/8")

Stack Bypass: 11" x 17", Legal, Letter, Letter-R,  
Executive, Statement-R, Envelope [No.10  
(COM10), Monarch, DL, ISO-C5], Custom  
Size (3-7/8" x 5-7/8" to 11-3/4" x 17")

### Supported Media Weights

Paper: 16 lb. Bond to 34 lb. Bond (60 to 128 g/m<sup>2</sup>)

Cassettes: 14 lb. Bond to 80 lb. Cover (52 to 220 g/m<sup>2</sup>)

Stack Bypass: 16 lb. Bond to 28 lb. Cover (60 to 105 g/m<sup>2</sup>)

### Warm-up Time

#### From Power On:

24 Seconds or Less

#### From Deep Sleep Mode:

10 Seconds or Less

#### Quick Startup Mode:

4 Seconds<sup>7</sup>

### Dimensions (W x D x H)

23-1/8" x 29-1/8" x 47" (587 mm x 740 mm x 1,193 mm)<sup>8</sup>

### Installation Space (W x D)

Basic [With ADF (Stack Bypass and Cassette Drawers Open)]: 35" x 46-1/2" (889 mm x 1,182 mm)

Fully Configured [With ADF+Paper Deck Unit-F1+  
Booklet Finisher-Y1 (Cassette Drawers Open)]:

71-3/8" x 50-3/8" (1,811 mm x 1,280 mm)

Weight: Approx. 240.7 lb. (109.2 kg)<sup>9</sup>

## Print Specifications

### Print Speed

455i: Up to 51 ppm (Letter); Up to 37 ppm  
(Letter-R); Up to 25 ppm (Legal);  
Up to 25 ppm (11" x 17")

4545i: Up to 45 ppm (Letter); Up to 32 ppm  
(Letter-R); Up to 25 ppm (Legal);  
Up to 22 ppm (11" x 17")

4535i: Up to 35 ppm (Letter); Up to 32 ppm  
(Letter-R); Up to 25 ppm (Legal);  
Up to 22 ppm (11" x 17")

4525i: Up to 25 ppm (Letter); Up to 17 ppm  
(Letter-R); Up to 13 ppm (Legal); Up to  
15 ppm (11" x 17")

### Standard Page Description Languages

UFR II, PCL<sup>®</sup>6, Adobe<sup>®</sup> PS<sup>®</sup> 3

### Direct Print

Available from USB, Advanced Box, Remote UI,  
and Web Access (Opt.)<sup>10</sup>

### Supported File Types for Direct Print

PDF, TIFF, JPEG, EPS, XPS

### Fonts

PCL fonts: 93 Roman, 10 Bitmap fonts, 2 OCR fonts,  
Andalé Mono WT J/K/S/T (Japanese,  
Korean, Simplified and Traditional  
Chinese),<sup>11</sup> Barcode Fonts<sup>12</sup>

PS fonts: 136 Roman

### Operating System<sup>13</sup>

UFR II/PS: Windows Vista<sup>®</sup>/Server 2008/Windows<sup>®</sup>  
7/Server 2008 R2/Windows 8/Server  
2012/Windows 8.1/Server 2012 R2/  
Windows 10, MAC OS X (10.6.8 or later)

PCL: Windows Vista/Server 2008/Windows  
7/Server 2008 R2/Windows 8/Server  
2012/Windows 8.1/Server 2012 R2/  
Windows 10

PPD: MAC OS 9.1 or later, MAC OS X (10.3.9  
or later), Windows Vista/Windows 7/  
Windows 8/Windows 8.1/Windows 10

## Copy Specifications

### Copy Speed

455i: Up to 51 ppm (Letter); Up to 37 ppm  
(Letter-R); Up to 25 ppm (Legal);  
Up to 25 ppm (11" x 17")

4545i: Up to 45 ppm (Letter); Up to 32 ppm  
(Letter-R); Up to 25 ppm (Legal);  
Up to 22 ppm (11" x 17")

4535i: Up to 35 ppm (Letter); Up to 32 ppm  
(Letter-R); Up to 25 ppm (Legal);  
Up to 22 ppm (11" x 17")

4525i: Up to 25 ppm (Letter); Up to 17 ppm  
(Letter-R); Up to 13 ppm (Legal); Up to  
15 ppm (11" x 17")

### First-Copy-Out Time (Letter)

455i: As fast as 3.7 seconds

4545i/4535i: As fast as 3.8 seconds

4525i: As fast as 5.2 seconds

### Copy Resolution

Reading: Up to 600 dpi x 600 dpi

Printing: 1200 dpi x 1200 dpi

Multiple Copies: Up to 999 copies

Magnification: 25%-400% (1% Increments)

Preset Reductions: 25%, 50%, 64%, 73%, 78%

Preset Enlargements: 121%, 129%, 200%, 400%

## Basic Copy Features

Preset Reduction/Enlargement Ratios by Area, Paper  
Setting, Previous Settings, Favorite Settings, Finishing,  
Two-Sided, Density Adjustment, Original Type Selection,  
Interrupt Mode, Setting Confirmation/Cancel

## Special Copy Features

Book to Two Pages, Two-sided Original, Finishing,  
Booklet, Job Build, N on 1, Add Cover, Insert Sheets,  
Different Size Originals, Density Adjustment, Original  
Type Selection, Transparency Cover Sheets, Page  
Numbering, Copy Set Numbering, Sharpness, Erase  
Frame, Secure Watermark, Print Date, Shift, Gutter,  
Print & Check, Negative/Positive, Repeat Images,  
Merge Job Blocks, Job Done Notice, Mirror Image,  
Store in Mail Box, Superimpose Image, Copy ID Card,  
Detect Feeder Multi Sheet Feed, Free Size Original

## Scan Specifications

### Type

455i/4545i: Standard Single Pass Duplexing  
Automatic Document Feeder

4535i/4525i: Optional Single Pass Duplexing  
Automatic Document Feeder or  
Duplexing Automatic Document Feeder

### Document Feeder Paper Capacity

Single Pass DADF-A1: 150 Sheets (20 lb. Bond)

DADF-AV1: 100 Sheets (20 lb. Bond)

### Document Feeder Supported Media Sizes

11" x 17", Legal, Letter, Letter-R, Statement, Statement-R

### Document Feeder Supported Media Weights

Single Pass DADF-A1

BW Original: 13 lb. Bond to 58 lb. Cover (50 to 157 g/m<sup>2</sup>)

CL Original: 17 lb. Bond to 58 lb. Cover (64 to 157 g/m<sup>2</sup>)

DADF-AV1

BW Original: 13 lb. Bond to 34 lb. Bond (50 to 128 g/m<sup>2</sup>)

CL Original: 17 lb. Bond to 34 lb. Bond (64 to 128 g/m<sup>2</sup>)

### Platen Acceptable Originals

Sheet, Book, 3-Dimensional Objects [Up to 4.4 lb. (2 kg)]

### Pull Scan

Color Network ScanGear2 for both Twain and WIA

Supported: Windows Vista/7/8/8.1/10

OS: Windows Server 2008/Server 2008 R2/  
Server 2012/Server 2012 R2

### Scan Resolution

600 x 600 dpi, 400 x 400 dpi, 300 x 300 dpi, 200 x 400 dpi,  
200 x 200 dpi, 200 x 100 dpi, 150 x 150 dpi, 100 x 100dpi

### Scan Speed (Letter)

Single Pass DADF-A1

Single-sided Scanning (BW):

80 ipm (300 dpi)/80 ipm (600 dpi)

Single-sided Scanning (Color):

80 ipm (300 dpi)/60 ipm (600 dpi)

Double-sided Scanning (BW):

160 ipm (300 dpi)/150 ipm (600 dpi)

Double-sided Scanning (Color):

160 ipm (300 dpi)/80 ipm (600 dpi)

DADF-AV1

Single-sided Scanning (BW/Color):

70 ipm (300 dpi)/51 ipm (600 dpi)

Double-sided Scanning (BW):

35 ipm (300 dpi)/25.5 ipm (600 dpi)

Double-sided Scanning (Color):

35 ipm (300 dpi)/25.5 ipm (600 dpi)

## Send Specifications

### Destination

E-mail/Internet Fax (SMTP), SMB, FTP, WebDAV, Mail  
Box, Super G3 Fax (Optional), IP Fax (Optional)

### Address Book

LDAP (2,000)/Local (1,600)/Speed dial (200)

### Send Resolution

600 x 600 dpi, 400 x 400 dpi, 300 x 300 dpi, 200 x 400 dpi,  
200 x 200 dpi, 200 x 100 dpi, 150 x 150 dpi, 100 x 100dpi

### Communication Protocol

File: FTP, SMB v3.0, WebDAV

E-mail/I-Fax: SMTP, POP3, I-Fax (Simple, Full)

## File Format

Standard: TIFF, JPEG, PDF(Compact, Searchable, Apply policy, Optimize for Web, PDF A/1-b), XPS (Compact, Searchable), Office Open XML (PowerPoint®, Word)

Optional: PDF (Trace & Smooth, Encrypted), PDF/XPS (Digital Signature)

## Universal Send Features

Original Type Selection, Two-sided Original, Book to Two Pages, Different-size Originals, Density Adjustment, Sharpness, Copy Ratio, Erase Frame, Job Build, Delayed Send, Preview, Finished Stamp, Job Done Notice, File Name, Subject/Message, Reply-to, E-mail Priority, TX Report, Original Content Orientation, Skip Blank Originals, Detect Feeder Multi Sheet Feed

## Fax Specifications

**Maximum Number of Connection Lines:** 4

### Modem Speed

Super G3: 33.6 Kbps  
G3: 14.4 Kbps

**Compression Method:** MH, MR, MMR, JBIG

### Resolution

400 x 400 dpi, 200 x 400 dpi, 200 x 200 dpi, 200 x 100 dpi

**Sending/Recording Size:** Statement-R to 11" x 17"

**Fax Memory:** Up to 30,000 pages

**Speed Dials:** Max. 200

**Group Dials/Destinations:** Max. 199 dials

**Sequential Broadcast:** Max. 256 addresses

**Memory Backup:** Yes

### Fax Features

Original Type Selection, Two-sided Original, Book to Two Pages, Different-size Originals, Density for Scanning, Sharpness, Copy Ratio, Erase Frame, Job Build, Specifying the Sender's Name (when sending fax), Sender's Name (TTI), Select Line, Selecting the Telephone Line (when sending fax), Direct Send, Delayed Send, Preview, Finished Stamp, Job Done Notice, TX Report, Detect Feeder Multi Sheet Feed

## Store Specifications

### Mail Box (Number Supported)

100 User In-boxes, 1 Memory RX In-box, 50 Confidential Fax In-boxes, 30,000 Maximum Pages Stored

### Advanced Box

Communication Protocol: SMB or WebDAV

Supported

Client PC: Windows (Windows Vista/7/8/8.1/10)

Concurrent Connections (Max.)

SMB: 64

WebDAV: 3 (Active Sessions)

## Advanced Box Available Disk Space

Approx. 16 GB (Standard HDD)  
Approx. 480 GB (Optional 1 TB HDD)

### Advanced Box Features:

Disabling Advanced Box, Storage Filtering, Authentication for Advanced Box Log-in, Search Function, Sort Function, Printing a PDF File with a Password, imageWARE Secure Audit Manager Support

### Memory Media

Standard: USB

## Security Specifications

### Authentication

Standard: Universal Login Manager, User Authentication, Department ID Authentication, Access Management System, Device and Function Level Log-in

Optional: uniFLOW

### Data

Standard: Trusted Platform Module (TPM), Hard Disk Password Lock, Hard Disk Drive Erase, Mail Box Password Protection, Hard Disk Drive Encryption(FIPS140-2 Validated)

Optional: Hard Disk Drive Mirroring, Hard Disk Drive removal, IEEE 2600.2 Common Criteria Certification, Data Loss Prevention (Requires uniFLOW)

### Network

Standard: IP/Mac Address Filtering, IPsec, TLS Encrypted Communication, SNMP V3.0, IEEE 802.1X, IPv6, SMTP Authentication, POP Authentication before SMTP

### Document

Standard: Secure Print, Forced Hold Printing, Adobe LiveCycle® Rights Management ES2.5 Integration

Optional: Encrypted PDF, Encrypted Secure Print, User and Device signatures, Secure Watermarks, Document Scan Locking

## Environmental Specifications

### Operating Environment

Temperature: 50 to 86°F

Humidity: 20 to 80% RH (no condensation)

### Power Requirements

455i: 120-127 V AC, 60 Hz, 10.4A

4545i/4535i: 120-127 V AC, 60 Hz, 9.3A

4525i: 120-127 V AC, 60 Hz, 7A

### Plug (Main Unit)

NEMA 5-15P

## Power Consumption

Maximum: Approx. 1.5 kWh

Standby: Approx. 38 W

Sleep Mode: Approx. 0.9 W<sup>14</sup>

Typical Electricity Consumption (TEC) Rating:

455i: 2.5 kWh

4545i: 2.2 kWh

4535i: 1.8 kWh

4525i: 1.0 kWh

### Standards

ENERGY STAR® Certified, Rated EPEAT® Gold<sup>3</sup>, RoHS Compliant

## Consumables

**Toner:** GPR-57 Toner BK

**Toner Yield (Estimated @ 6% Coverage)**

Black: 42,100 Images

## Footnotes

<sup>1</sup> Subscription to a third-party cloud service required. Subject to third-party cloud service providers' terms and conditions.

<sup>2</sup> Canon products offer certain security features, yet many variables can impact the security of your devices and data. Canon does not warrant that use of its features will prevent security issues. Nothing herein should be construed as legal or regulatory advice concerning applicable laws; customers must have their own qualified counsel determine the feasibility of a solution as it relates to regulatory and statutory compliance.

<sup>3</sup> For current EPEAT rating (Gold/Silver/Bronze), please visit [www.epeat.net](http://www.epeat.net).

<sup>4</sup> Requires the optional Inner 2/3 Hole Puncher-C1.

<sup>5</sup> Booklet Finisher-Y1 only.

<sup>6</sup> Requires the optional 2/3 Hole Puncher Unit-A1.

<sup>7</sup> Time from device power-on to when copy jobs can be programmed.

<sup>8</sup> Includes Main Unit, Single Pass DADF-A1, and Cassette Feeding Unit-ANI.

<sup>9</sup> Includes Main Unit, Single Pass DADF-A1, Cassette Feeding Unit-ANI, and consumables.

<sup>10</sup> PDF print from Web sites is supported.

<sup>11</sup> Requires the optional PCL International Font Set-A1.

<sup>12</sup> Requires the optional Barcode Printer Kit-D1.

<sup>13</sup> Other operating systems and environments including AS/400, UNIX, Linux and Citrix may be supported. Some of these solutions are chargeable. SAP Device Types are available via the SAP Market Place. For more information, contact your sales representative.

<sup>14</sup> 0.9 W Sleep mode is not available in all circumstances due to certain settings.

USA.CANON.COM



Canon U.S.A. does not provide legal counsel or regulatory compliance consultancy, including without limitation, Sarbanes-Oxley, HIPAA, GLBA, Check 21 or the USA Patriot Act. Each customer must have its own qualified counsel determine the advisability of a particular solution as it relates to regulatory and statutory compliance.

As an ENERGY STAR® Partner, Canon U.S.A., Inc. has certified these models as meeting the ENERGY STAR energy efficiency criteria through an EPA recognized certification body. ENERGY STAR and the ENERGY STAR mark are registered U.S. marks. Canon, imageRUNNER, imageWARE, and the GENUINE logo are registered trademarks or trademarks of Canon Inc. in the United States and may also be registered trademarks or trademarks in other countries. Google Cloud Print™ is either a registered trademark or trademark of Google Inc. AirPrint and the AirPrint logo are trademarks of Apple Inc. Adobe® and PostScript® 3™ are either registered trademarks or trademarks of Adobe Systems Incorporated in the United States and/or other countries. Microsoft® and PowerPoint® are either registered trademarks or trademarks of Microsoft Corporation in the United States and/or other countries. PCL® is a registered trademark of Hewlett-Packard Company. All other referenced product names and marks are trademarks of their respective owners. All features presented in this brochure may not apply to all Series and/or products and may be optional; please check with your Canon Authorized Dealer for details. Products shown with optional accessories. Specifications and availability subject to change without notice. Not responsible for typographical errors. ©2017 Canon U.S.A., Inc. All rights reserved.

0205W713  
0717RI-iRA45xxSSS-6M-DIH

